

PUBLIC HEARING

Per W.S. 22-7-102, NOTICE is hereby given that the following Public Hearing will be held on May 1, 2012 at 11:00 a.m. at the Weston County Commissioners' Meeting, Weston County Courthouse, 1 West Main, Newcastle, Wyoming, to obtain public comment on the following proposed voter precinct boundary changes:

The boundaries for Precincts 1-1, 1-2, 2-1, 3-1, 4-1, and 5-1 will remain unchanged. The boundaries between precincts 5-2 and 5-3 will be slightly adjusted. The proposed change will more evenly distribute the voter population between the two precincts which are located within the city limits of Newcastle.

**Precincts 5-2 and 5-3 Proposed Boundary Change:** Beginning at the current Railroad dividing boundary, South on 2<sup>nd</sup> Avenue, West on Sunset Street to 3<sup>rd</sup> Avenue, South on 3<sup>rd</sup> Avenue to West Main Street, West on West Main to Newcastle city limits.

Map #1 shows the current boundaries of the Newcastle Inside Precincts 5-1, 5-2, and 5-3.

Map #2 shows the proposed changes between Precinct Boundaries 5-2 and 5-3.

Map #3 shows the boundary for House and Senate Districts within Weston County. Due to Legislative Redistricting, the Southern half of Weston County will now be in Senate District 3, the Northern half of Weston County remains in Senate District 1. The House Districts have not changed the Northern half of Weston County is in House District 1 and the Southern half of Weston County is in House District 2.

For more information or detailed maps please contact the Weston County Clerk's Office, or visit our website at: <http://westongov.com>

Mamie C. Krank  
Weston County Clerk

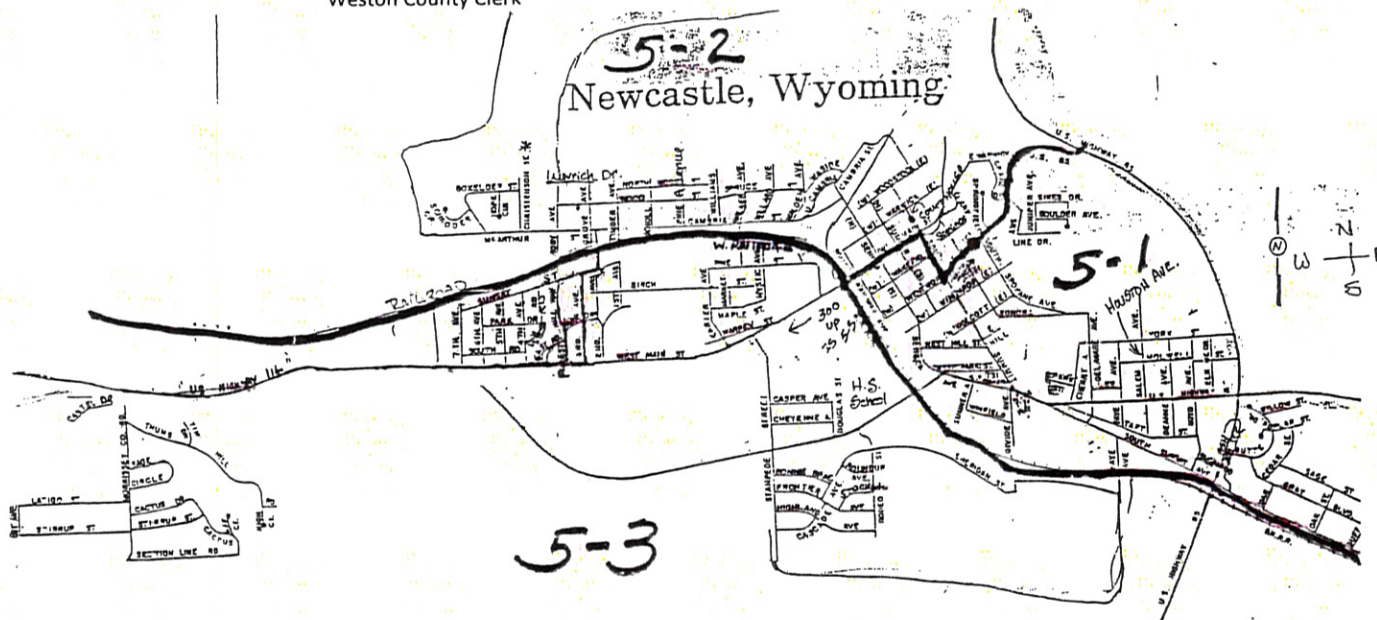

MAP #1 CURRENT BOUNDARIES

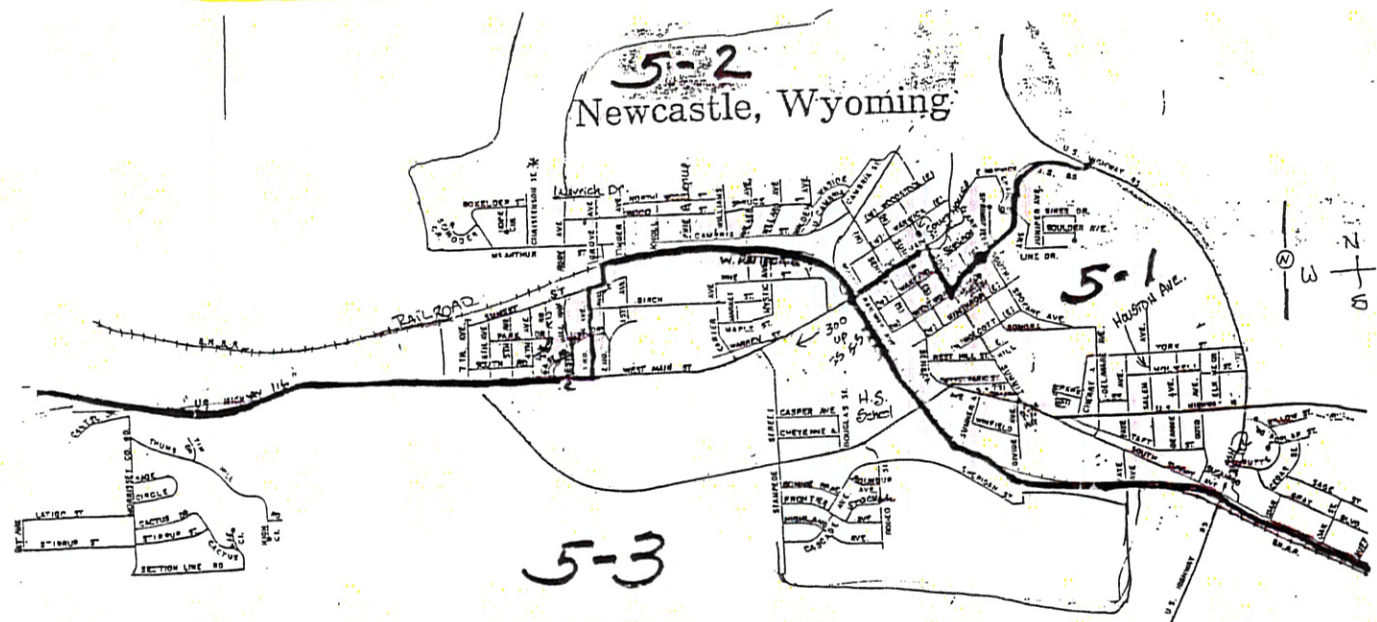

MAP #2 PROPOSED BOUNDARY CHANGES

Weston County, Wyoming  
Map #3 Legislative Redistricting  
House and Senate Boundaries

